



Headley Walk

HEADLEY PARK

APPROXIMATE FLOOR AREA
82 SQM / 876 SQFT



GROUND FLOOR



FIRST FLOOR

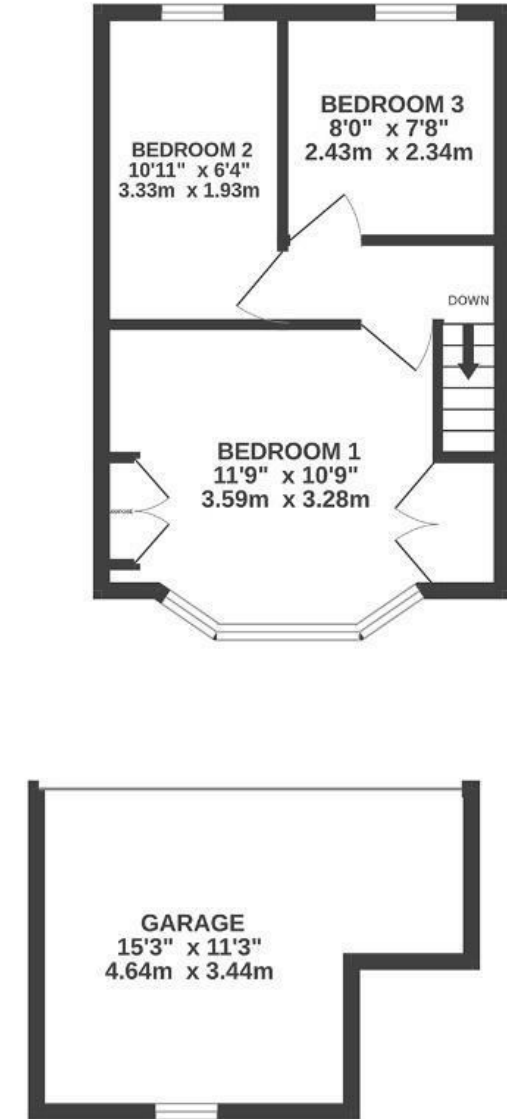

Boardwalk

Headley Walk

, BRISTOL



£325,000



3 Bedrooms



BS13 7NS



1 Bathrooms

"I love cozying up in the garden both in the sun and the rain. The lean-to pergola acts as a sun trap, making the space feel warmer and sheltered."

